



SPINNING REEL



GBAT2000/3000/5000/8000/10000

GEAR RATIO <5.2/4.1>

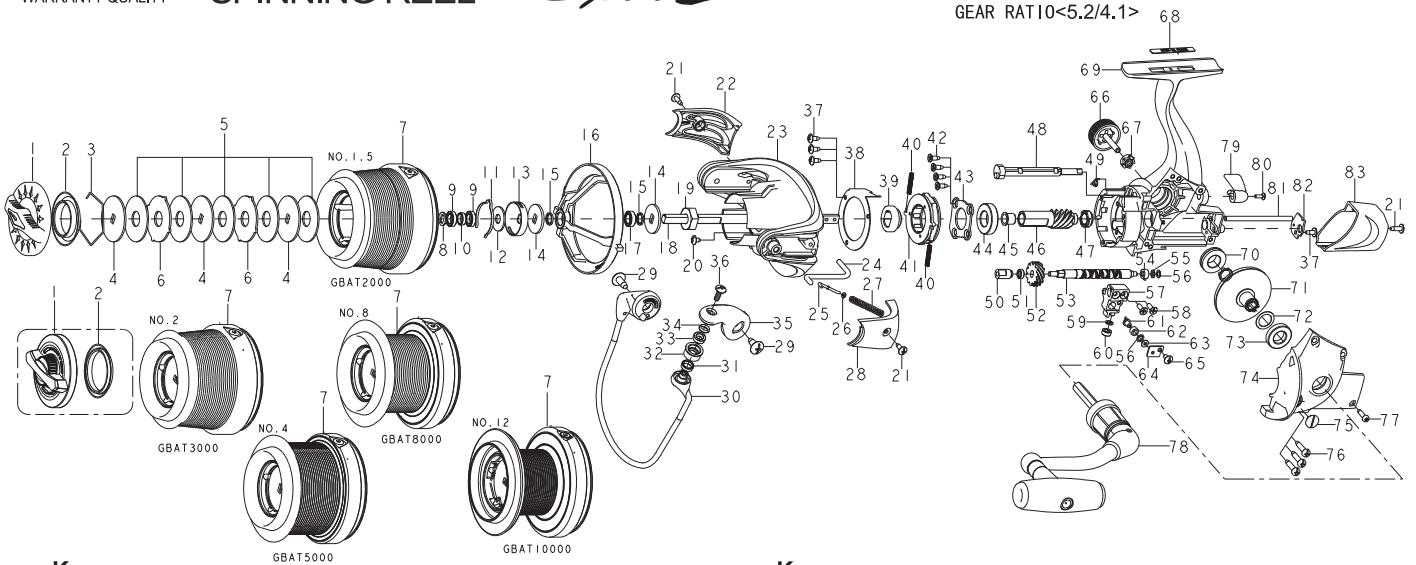

Key NO.	Parts No.	Parts name	Key NO.	Parts No.	Parts name
1	2YD-123-01	DRAG KNOB ASSEMBLY	51	2C1-048-01	WORM SHAFT COLLAR
2	2E9-054-01	PROOF WATER RING	52	2G3-025-01	OSCILLATING GEAR
3	2E4-003-01	DRAG WASHER RETAINER	53	2M4-012-01	WORM SHAFT
4	2W2-048-02	KEY WASHER	54	2C2-035-01	WORM SHAFT BUSH A
5	2W1-175-02	100-300 WASHER	55	2W1-058-02	030-050 WASHER
6	2W3-027-01	EARED WASHER	56	2W1-058-04	030-050 WASHER
7	2YT-552-01	SPOOL TOTAL ASSEMBLY	57	2M1-020-01	OSCILLATING SLIDER
8	2W2-041-01	KEY WASHER	58	2E2-052-02	F26M-080 SCREW
9	2Z1-030-05	610-2.5 BALL BEARING	59	2W1-058-03	030-050 WASHER
10	2C1-143-01	SPACER	60	2Z1-014-05	306-2.5 BALL BEARING
11	2L3-018-01	CLICK LEAF SPRING	61	2M5-004-01	LINE GUIDE PIN
12	2W1-115-01	061-160 WASHER	62	2C2-034-01	LINE GUIDE PIN BUSH
13	2F8-027-02	CLICK LEAF SPRING HOLDER	63	2W1-059-01	020-049 WASHER
14	2W2-034-01	KEY WASHER	64	2F5-103-01	OSCILLATING SLIDER COVER
15	2C1-145-01	SPACER	65	2E2-006-03	B26M-050 SCREW
16	2F1-020-01	LINE ANTI-FALL RING	66	2H6-002-08	HANDLE SCREW CAP
17	2Z1-013-05	610-3 BALL BEARING	67	2C3-047-01	HANDLE SCREW SLEEVE
18	2M3-181-01	MAIN SHAFT	68	2N2-028-11	FOOT NAME PLATE
19	2E3-097-01	ROTOR NUT	69	2B1-221-01	BODY
20	2E1-036-01	B26-040 SCREW	70	2Z2-010-01	BUSHING
21	2E1-016-02	B26-080 SCREW	71	2G1-029-02	DRIVE GEAR
22	2R4-240-01	BAIL TRIP COVER	72	2W1-014-03	091-130 WASHER
23	2R1-175-03	ROTOR	73	2Z1-007-05	917-4 BALL BEARING
24	2R5-218-01	BAIL PAWL	74	2B2-158-01	BODY COVER
25	2R5-040-01	BAIL TRIP SHAFT	75	2F5-511-01	GEAR GREASE CAP
26	2W1-044-01	016-035 WASHER	76	2E1-006-02	A30-130 SCREW
27	2Q1-143-01	BAIL SPRING	77	2E1-055-01	A26-100 SCREW
28	2R4-241-01	BAIL SPRING COVER	78	2YH-199-03	HANDLE TOTAL ASSEMBLY
29	2E1-014-01	B40-100 SCREW	79	2A1-025-19	ANTI-REVERSE LEVER
30	2YL-205-01	BAIL ASSEMBLY	80	2E2-013-02	B20M-060 SCREW
31	2C1-068-01	COLLAR	81	2P1-029-01	OSCILLATING SLIDER PIN
32	2R6-018-02	LINE ROLLER	82	2F5-509-01	WORM SHAFT COVER
33	2Z1-001-05	508-2.5 BALL BEARING	83	2F5-507-01	REAR COVER
34	2W4-021-01	LINE ROLLER NUT SPACER			
35	2R2-088-01	BAIL ARM	QUICK-SET PRAG SYSTEM	SPECIAL PARTS	
36	2E2-007-01	B30M-100 SCREW	1	2YD-122-01	QUICK-SET PRAG SYSTEM ASSEMBLY
37	2E1-015-02	B26-060 SCREW	2	2E9-057-01	PROOF WATER RING
38	2F5-196-01	ROLLER CLUTCH RETAINER	GBAT3000	SPECIAL PARTS	
39	2A4-034-01	ONE-WAY CLUTCH INNER TUBE	7	2YT-553-01	SPOOL TOTAL ASSEMBLY
40	2Q1-071-01	CAGE SPRING	GBAT5000	SPECIAL PARTS	
41	2YZ-015-01	ONE-WAY CLUTCH BEARING ASSEMBLY	7	2YT-554-01	SPOOL TOTAL ASSEMBLY
42	2E1-063-01	F26-070 SCREW	GBAT8000	SPECIAL PARTS	
43	2F5-178-01	BEARING RETAINER	7	2YT-555-01	SPOOL TOTAL ASSEMBLY
44	2Z1-008-05	1020-5 BALL BEARING	GBAT10000	SPECIAL PARTS	
45	2C1-142-01	PINION GEAR BUAH	3	2E4-048-01	DRAG WASHER RETAINER
46	2G2-188-01	PINION GEAR	7	2YT-556-01	SPOOL TOTAL ASSEMBLY
47	2Z2-013-01	BUSHING	GEAR RATIO 4.1	SPECIAL PARTS	
48	2A2-041-01	ANTI-REVERSE CAM	23	2R1-175-01	ROTOR
49	2Q3-072-01	ANTI-REVERSE SPRING	46	2G2-189-01	PINION GEAR
50	2C2-049-01	WORM SHAFT BUSH C	52	2G3-035-01	OSCILLATING GEAR
			71	2G1-045-02	DRIVE GEAR