

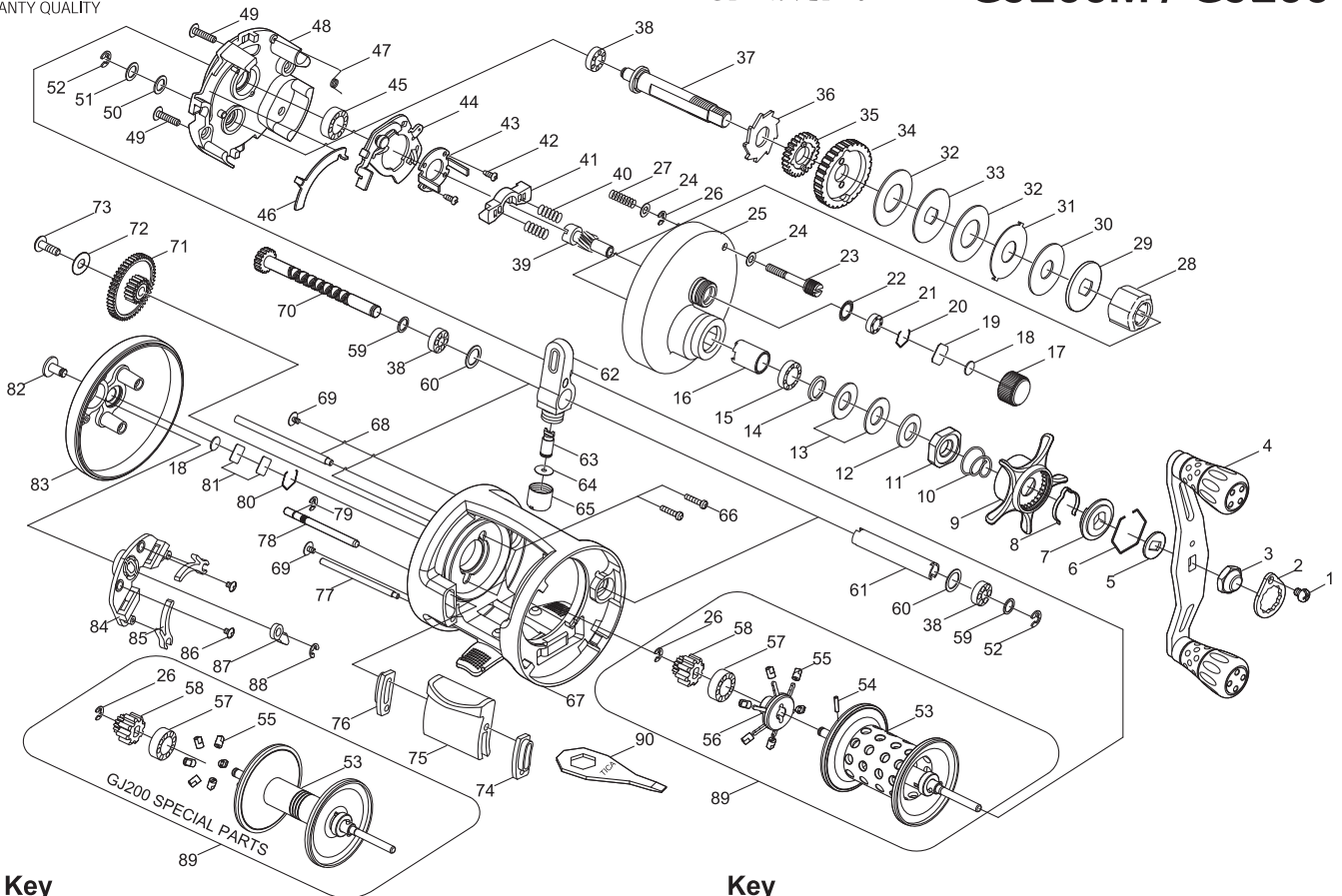

# BAIT CASTING REEL

# CAIMAN

# GJ200M / GJ200



Key No.	Parts No.	Parts name	Key No.	Parts No.	Parts name
1	2E2-089-01	A26M-045 SCREW	48	2F8-039-01	GEAR SETTING PLATE
2	2F6-043-02	ROTOR NUT HOLDING PLATE	49	2E2-005-03	B26M-080 SCREW
3	2E3-075-01	HANDLE NUT	50	2W1-054-01	052-080 WASHER
4	2YH-312-03	HANDLE TOTAL ASSEMBLY	51	2W1-070-01	052-080 WASHER
5	2W2-058-01	KEY WASH	52	2E5-013-01	E3.0 RETAINER
6	2E4-018-01	RETAINER	53	2YS-255-03	SPOOL ASSEMBLY
7	2F8-050-01	CLICK LEAF SPRING HOLDER	54	2E6-017-01	SPOOL SHAFT PIN
8	2L3-029-01	CLICK LEAF SPRING	55	2C2-057-01	BRAKE COLLAR
9	2D4-008-02	STAR DRAG LEVER	56	2YS-257-01	TIP OF SPOOL ASSEMBLY
10	2Q1-052-01	STAR DRAG SPRING	57	2Z1-023-01	814-4 BALL BEARING
11	2E3-029-01	STAR DRAG NUT	58	2F3-041-01	CLICK GEAR
12	2W1-020-01	081-130 WASHER	59	2W1-046-01	051-068 WASHER
13	2L1-004-01	SPRING WASHER	60	2W1-078-01	072-100 WASHER
14	2W1-035-05	080-105 WASHER	61	2C4-010-01	LEVEL WIND GUARD
15	2Z1-024-05	812-2.5 BALL BEARING	62	2YR-038-01	LINE GUIDE ASSEMBLY
16	2A4-022-01	ONE-WAY CLUTCH INNER TUBE	63	2M5-005-01	LINE GUIDE PIN
17	2E3-024-01	CAST CONTROL NUT	64	2W1-100-01	020-068 WASHER
18	2W5-026-01	SPACER	65	2E3-014-01	LINE GUIDE NUT
19	2W5-029-01	CAST CONTROL SPACER	66	2E2-034-01	A20M-090 SCREW
20	2E4-019-01	BEARING RETAINER	67	2YB-095-10	BODY ASSEMBLY
21	2Z1-001-05	508-2.5 BALL BEARING	68	2P4-006-03	LEVEL WIND GUIDE
22	2E9-005-01	O RING	69	2E2-003-01	B26M-036 SCREW
23	2E0-011-01	RIGHT SIDE COVER SCREW	70	2YM-042-01	WORM SHAFT ASSEMBLY
24	2W1-132-01	036-060 WASHER	71	2G3-015-01	IDLE GEAR
25	2YF-033-25	RIGHT SIDE COVER ASSEMBLY	72	2W1-166-02	031-102 WASHER
26	2E5-006-01	E2.5 RETAINER	73	2E2-007-01	B30M-100 SCREW
27	2Q1-056-01	RIGHT SIDE COVER SCREW SPRING	74	2C4-013-02	CASTING BAR GUIDE A
28	2YZ-007-01	ONE-WAY CLUTCH BEARING ASSEMBLY	75	2YS-085-02	CASTING BAR ASSEMBLY
29	2W2-032-01	KEY WASHER	76	2C4-014-02	CASTING BAR GUIDE B
30	2W1-126-01	082-210 WASHER	77	2P4-008-03	CASTING BAR SUPPORT
31	2W3-017-01	EARED WASHER	78	2P2-021-01	CASTING BAR PIN
32	2W1-111-01	100-230 WASHER	79	2E5-020-01	E1.5 RETAINER
33	2W2-025-01	KEY WASHER	80	2E4-011-01	BEARING RETAINER
34	2G1-027-01	DRIVE GEAR	81	2W5-015-01	CAST CONTROL SPACER
35	2YG-023-01	OSCILLATING GEAR ASSEMBLY	82	2F7-004-01	CLICK SWITCH
36	2A3-027-01	RATCHET	83	2F5-108-14	LEFT SIDE COVER
37	2M3-053-01	DRIVE SHAFT	84	2F6-032-01	CLICK PLATE
38	2Z1-018-05	510-3 BALL BEARING	85	2F2-020-01	CLICK SPRING
39	2G2-010-01	PINION GEAR	86	2E2-022-01	B20M-030 SCREW
40	2Q1-031-01	YOKE SPRING	87	2F4-018-01	CLICK PAWL
41	2A2-039-01	PINION YOKE	88	2E5-006-01	E2.5 RETAINER
42	2E2-047-01	A20M-065 SCREW	89	2YT-398-03	SPOOL TOTAL ASSEMBLY
43	2F8-030-01	CLUTCH CAM RETAINER	90	2X3-004-02	WRENCH
44	2YA-035-01	CLUTCH CAM ASSEMBLY	GJ200	SPECIAL PARTS	
45	2Z1-010-05	812-3.5 BALL BEARING	25	2YF-033-22	RIGHT SIDE COVER ASSEMBLY
46	2M2-003-01	CLUTCH PLATE	53	2YS-083-04	SPOOL ASSEMBLY
47	2Q3-086-01	RETRACTOR SPRING	89	2YT-143-04	SPOOL TOTAL ASSEMBLY